

Carlin AND BIASI

SELECT

Engineered for 3-Pass Boilers



- 1 Pro-X 70200 Primary Control**
Advanced diagnostics and plain language display for fast, accurate repairs.
- 2 Pro-X 45000 Ignitor**
The latest ignitor technology to deliver the strongest spark, longest lasting performance.
- 3 Combustion Head Adjustability**
Simple setup and calibration thanks to our head position indicator and "One-Size" screw/nut adjustments.
- 4 Stainless Steel Flame Wrap**
For increased flame head heat retention delivering smooth light-off and quiet combustion.
- 5 OEM Specifications**
Factory set to Biasi requirements for optimal performance straight out of the box.
- 6 EZ Design**
Developed with the Tech in mind for simplified installation, setup and servicing.

Get the **PRO-X** 70200 Primary Control standard when you order your **BIASI** B10 Series with the Carlin Select Oil Burner.

Carlin[®]
Combustion Technology

126 Bailey Road • North Haven, CT 06473 • 203-680-9401
www.carlincombustion.com

Carlin SELECT

Advanced Oil Burner for 3-Pass Boilers

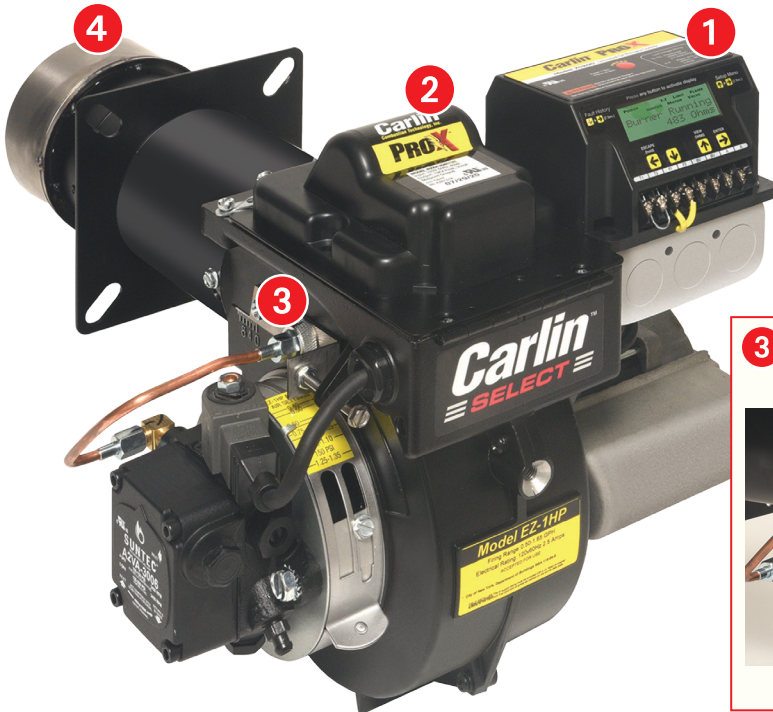

- 1 Carlin Pro-X 70200 Universal Control
Includes Large LCD display, Last Fault Alert, 3 different ignition types, Xtreme Diagnostics, and more!
- 2 Carlin Pro-X 45000 Universal Ignitor
Built tough for continuous use
- 3 Combustion Head Adjustability
Simple setup and calibration thanks to head position indicator and "One-Size" screw/nut adjustments.
- 4 Stainless Steel Flame Wrap
Improved flame head heat retention

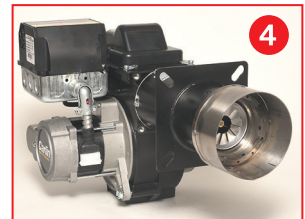
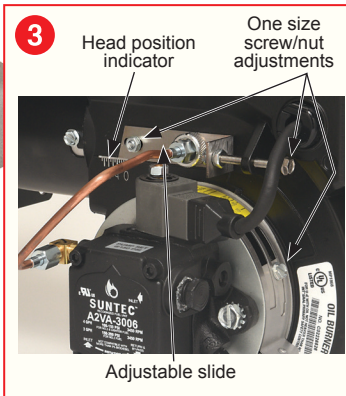

CARLIN SELECT SPECIFICATIONS

Input

0.50 to 1.65 GPH
70,000 to 364,000 BTUH

Fuels

U.S. – No. 1 or No. 2 Fuel oil
Canada – No. 1 Stove oil or
No. 2 Furnace oil

Electrical

Power – 120 VAC/60 Hz/1-phase
Current – Approximately 2.5 amps
Limit circuit input – 120 VAC/60 Hz
Motor (PSC) – 1/6 HP, 3450 RPM
Oil valve power – 120 VAC/60 Hz
Alarm contacts (isolated) – 24 VAC/VDC, 2 amps

Ignition

Carlin Model Pro-X 45000 solid state electronic ignitor
Ignition voltage – 19,000 volts

Control

- Carlin Model Pro-X 70200 microprocessor control
- Pinpoints cause of burner faults for fast, accurate repairs.
- 3 different ignition options (Smart, Interrupted and Intermittent).
- Last Fault Alert – Displays fault reason, even if homeowner resets control.
- Larger LCD Display – Plain language fault messages with no codes to decipher for fast, accurate repairs.

Operating Temperature Limits

Maximum ambient – 140°F (60°C)

Agencies

UL Listed (US & Canada)



PRO X 70200 Xtreme Diagnostics

Icons and plain language messages clearly identify the cause of fault condition. Detailed history of last 32 faults takes guesswork out of troubleshooting.

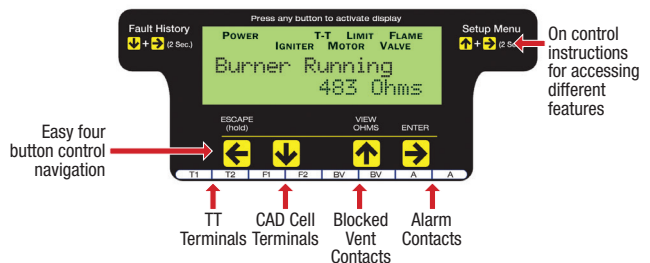

Last Fault Alert – Real diagnostics that spell out what the problem is when your technician arrives on the job even if control has been reset. At the right is a snapshot of what you could see on a no heat call.

Last Fault
No Flame Chk Vlv
Toggles every 3 seconds

To Clear Messages
Hold [ESC] 3 Sec

Carlin
Combustion Technology

126 Bailey Road
North Haven, CT 06473
203-680-9401
www.carlincombustion.com