

**Model 98435S:** Includes circuit board, quick connect wire harness, 24VAC transformer

**Model 98435S1:** Includes circuit board, quick connect wire harness

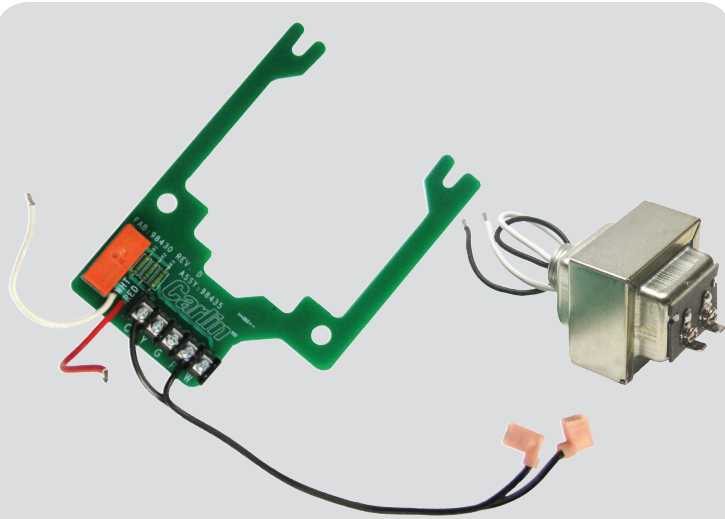

- Universal Fit: Works with Carlin, Beckett and Honeywell primary controls
- Replaces Beckett 51950U Ready Kit or 51970U Terminal base
- Replaces Honeywell R8184M when installed with Carlin primary control
- Heavy Duty 16 Amp Relay for added durability
- Designed for quick installation

<b>Transformer input (primary)</b>	120 VAC, 60 HZ
<b>Transformer output (secondary)</b>	24 VAC, 60 HZ, 40 VA
<b>Control specifications</b>	Refer to primary control data sheet

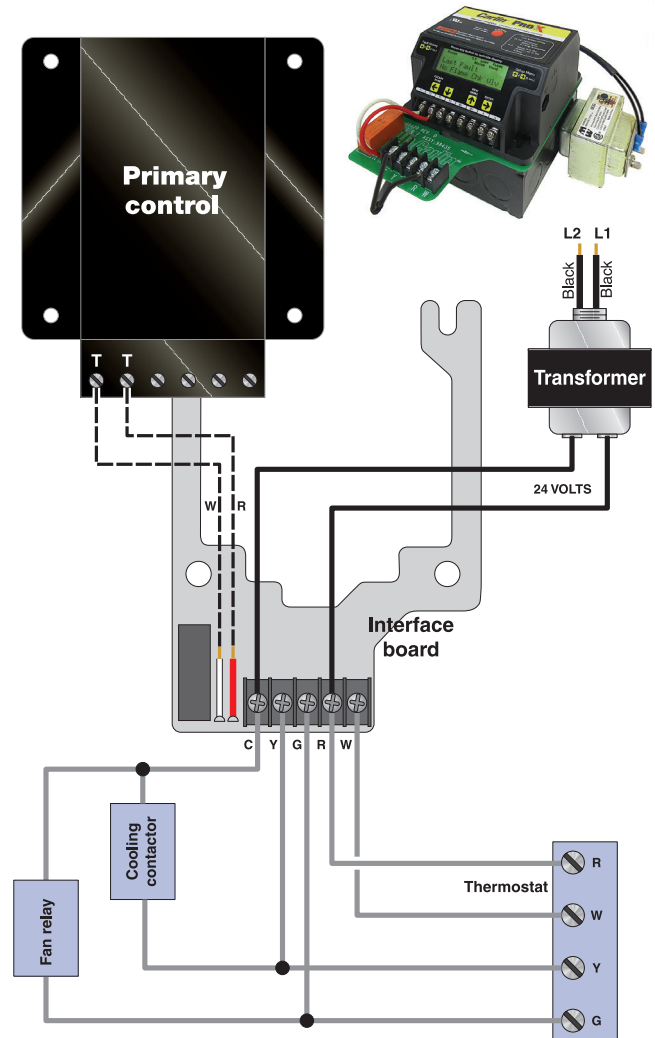

## Installing & Wiring

### Warning

1. The 98435S kit must be installed only by a qualified service technician.
2. Always disconnect power source before wiring to avoid electrical shock or damage to the control. All wiring must comply with applicable codes and ordinances.
3. Thermostat terminals (T-T) provide a current source. Never apply external power to these terminals under any circumstances.

### Mounting

- Mount the interface board on the burner 4x4 junction box as shown in typical installation photo above, right column. Insert the transformer hub through a junction box knockout and secure with lock nut.
- The control location must not exceed the ambient temperature limit, listed in the primary control data sheet.

### Wiring

- Wiring must comply with local and national electrical codes, and in accordance with the wiring diagram above.
- Wire the primary control per burner and control instructions. Wire control terminals T-T as shown above only.

### Mounting

1. **Fan and cooling check** – Set thermostat to call for cooling or fan. Verify correct operation.
2. **Heating control check** – Set thermostat to call for heat. Follow the primary control data sheet checkout procedure to verify.
3. If control does not operate correctly, check all wiring and wiring connections.

Tech Support: 800-989-2275

carlincombustion.com